

SpinTel 5G Home Wireless Broadband Set Up Guide

Choose your modem to start the setup process:

	<u>Nokia FastMile R1 5G Modem</u>
	<u>Nokia FastMile Gateway 3 5G Modem</u>
	<u>Nokia FastMile 3.2 5G Modem</u>



SpinTel Ultra Wi-Fi Home WBB Modem



Nokia FastMile R1 5G Modem

Follow the instructions below to set up your 5G Modem (Nokia FastMile) for 5G Home Wireless Broadband service.

Step 1: Activate Your Service

- Visit the [activation page](#) to activate your service. **Note:** The modem includes a pre-inserted SIM card. During the activation process, you may verify the last 4-5 digits of the SIM card using the letter that came

with the modem.

- Once activated, you'll receive a confirmation email. After that, you're ready to set up your modem.

Step 2: Find the Best Location for Your Modem

- Choose a clear, elevated spot near a window with easy access to an electrical outlet.
- Avoid placing the modem in direct sunlight to prevent overheating.
- Avoid locations like the floor, inside cupboards, or near metal objects, as these may weaken the signal.
- Test different spots if the initial location does not provide a strong signal.

Step 3: Power On the Modem

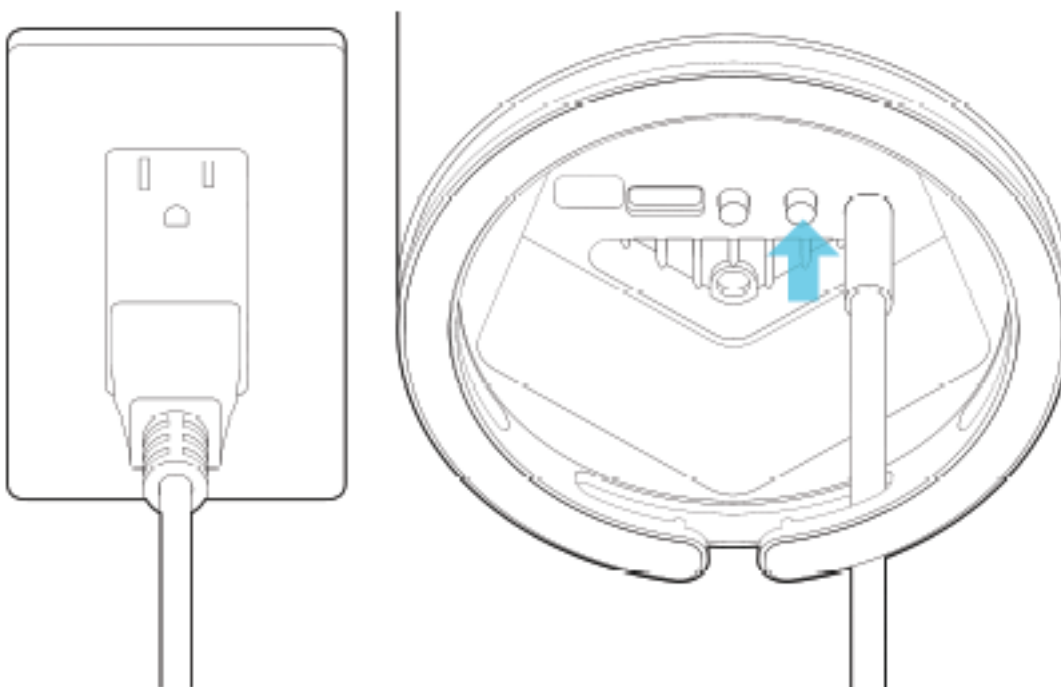

1. Connect the modem to an electrical outlet using the supplied power cable.
2. Turn on the modem using the ON/OFF button located at the base.
3. Allow about 5 minutes for the modem to boot up and configure.

Step 4: Check the 5G Signal Strength

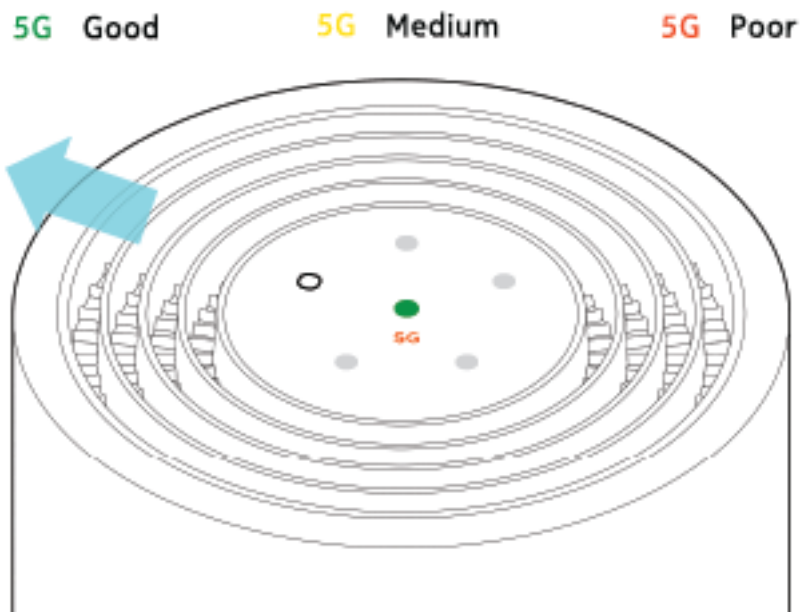

- If the 5G light is off or shows a weak signal (orange or red), try moving the modem to a better location, such as near a window.
- Use the Signal Direction light on the outer ring of the LED panel to help identify the direction of the strongest 5G signal.

Step 5: Connect Your Devices

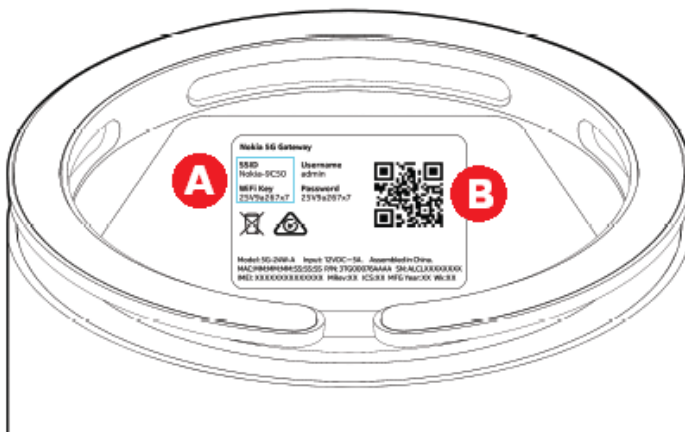

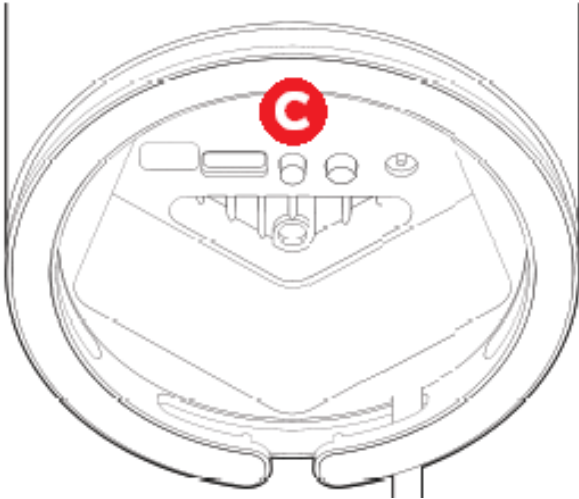

- **Option A:** Use the WiFi Network Name (SSID) and Password printed on the barcode sticker at the base of the modem.
- **Option B (Smartphones):** Scan the WiFi QR code on the barcode sticker.
- **Option C:** Enable WiFi Protected Setup (WPS) on your device, then press the WPS button on the modem's base.
- The modem will connect your devices to the best available network (e.g., 5GHz WiFi). Note that older devices may only connect to the slower 2.4GHz band.

Optional: Wired Connection

- Using an Ethernet cable, connect a computer or device to one of the three LAN ports on the modem's base.

For additional tips, refer to the guide on [finding the best 5G signal](#).

Nokia FastMile Gateway 3 5G Modem



Step 1: Activate Your Service

- Visit the [activation page](#) to activate your service. **Note:** The modem includes a pre-inserted SIM card. During the activation process, you may verify the last 4-5 digits of the SIM card using the letter that came with the modem.
- Once activated, you'll receive a confirmation email. After that, you're ready to set up your modem.

Step 2: Find the Best Location for Your Modem

- Choose a clear, elevated spot near a window with easy access to an electrical outlet.
- Avoid placing the modem in direct sunlight to prevent overheating.
- Avoid locations like the floor, inside cupboards, or near metal objects, as these may weaken the signal.
- Test different spots if the initial location does not provide a strong signal.

Step 3: Power On the Modem

1. Connect the modem to an electrical outlet using the supplied power cable.
2. Turn on the modem using the ON/OFF button located at the base.
3. Allow about 5 minutes for the modem to boot up and configure.

Step 4: Check the 5G Signal Strength

- The LCD touchscreen should show "5G Signal", coverage bars indicating the signal strength and 2x dots showing the internal antenna in use. If the 5G light is off or shows a weak signal bar, try moving the modem to a better location, such as near a window.

Step 5: Connect Your Devices

- **Option A:** Use the WiFi Network Name (SSID) and Password printed on the barcode sticker at the base of the modem.
- **Option B (Smartphones):** Scan the WiFi QR code on the barcode sticker.
- **Option C:** Enable WiFi Protected Setup (WPS) on your device, then press the WPS button on the modem's base.
- The modem will connect your devices to the best available network (e.g., 5GHz WiFi). Note that older devices may only connect to the

slower 2.4GHz band.

Optional: Wired Connection

- Using an Ethernet cable, connect a computer or device to one of the three LAN ports on the modem.

For additional tips, refer to the guide on [finding the best 5G signal](#).

Nokia FastMile 3.2 5G Modem

Follow the instructions below to set up your 5G Modem (Nokia FastMile 3.2 5G modem).

Step 1: Activate Your Service

- Visit the [activation page](#) to activate your service. **Note:** The modem includes a pre-inserted SIM card. During the activation process, you may verify the last 4-5 digits of the SIM card using the letter that came with the modem.
- Once activated, you'll receive a confirmation email. After that, you're ready to set up your modem.

Step 2: Find the Best Location for Your Modem

- Choose a clear, elevated spot near a window with easy access to an electrical outlet.
- Avoid placing the modem in direct sunlight to prevent overheating.
- Avoid locations like the floor, inside cupboards, or near metal objects, as these may weaken the signal.
- Test different spots if the initial location does not provide a strong signal.

Step 3: Power On the Modem



1. Connect the modem to an electrical outlet using the supplied power cable.
2. Turn on the modem using the ON/OFF button located at the base.
3. Allow about 5 minutes for the modem to boot up and configure.

Step 4: Check the 5G Signal Strength

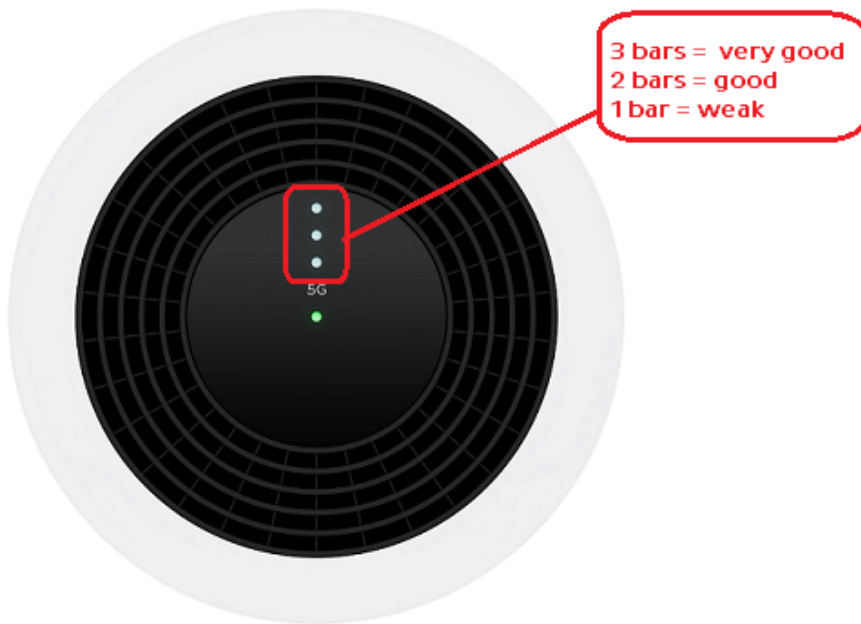

- If the 5G light is off or shows a weak signal, try moving the modem to a better location, such as near a window.

Step 5: Connect Your Devices



- **Option A:** Use the WiFi Network Name (SSID) and Password printed on the barcode sticker at the base of the modem.
- **Option B (Smartphones):** Scan the WiFi QR code on the barcode sticker.
- **Option C:** Enable WiFi Protected Setup (WPS) on your device, then press the WPS button on the modem's base.
- The modem will connect your devices to the best available network (e.g., 5GHz WiFi). Note that older devices may only connect to the slower 2.4GHz band.

Optional: Wired Connection



- Using an Ethernet cable, connect a computer or device to one of the three LAN ports on the modem.

For additional tips, refer to the guide on [finding the best 5G signal](#).

SpinTel Ultra Wi-Fi Home WBB Modem

Note: The modem includes a pre-inserted SIM card. During the activation process, you may verify the last 4-5 digits of the SIM card using the letter that came with the modem. To activate the service, visit the [activation page](#).

Powering On & Positioning the Modem



1. Place the modem near a window with a nearby power outlet.
2. Connect one end of the AC power cord to the modem and the other end to the power supply.
3. Turn on the modem using the on/off button on the back.
4. Wait 30 seconds for the modem to power up. The screen will turn on.

Checking the Status Bars

Your modem may get a better connection in different parts of your home. For best results, place it close to a window. For handy tips, see [finding the best 5G signal](#).

1. Position the modem near a window, away from obstructions.
2. Connect the power cable to the modem and plug it into a wall outlet.
3. The modem will display a 'booting' message.
4. It will search for the nearest Optus 5G tower and configure its internal antenna for optimal signal strength. This may take a few minutes.

5. The screen will show 'Your connection is...' with bars indicating signal strength.



After connecting, the modem might automatically update its firmware within the first 24 hours, typically overnight to avoid disrupting your internet connection.

Navigating the Modem Screen

The modem features a color LCD screen with three buttons for easy access to your 5G connection details:

- Mobile signal strength
- Main WiFi Details
- WiFi on/off toggle
- WiFi Protected Setup (WPS) pairing for WPS-compatible devices
- Screen brightness
- WiFi Settings summary
- Mobile settings summary (across two screens)
- Help and support

2. Select the correct WiFi network from your device's list of available networks and enter the password to connect.
3. To optimize your WiFi experience:
 - Place the modem at least one meter off the floor in a central location in your home or office.
 - Ensure there is space and ventilation around the modem.
 - Avoid placing the modem near large appliances and Bluetooth devices.

Connecting Using an Ethernet Cable

1. Connect your devices directly to the modem using the supplied Ethernet cable.
2. Plug one end of the Ethernet cable into a LAN port on the modem.
3. Plug the other end into your device.



For additional tips, refer to the guide on [finding the best 5G signal](https://articles.spintel.net.au/article/spintel-5g-home-wireless-broadband-set-up-guide.html).

Online URL:

<https://articles.spintel.net.au/article/spintel-5g-home-wireless-broadband-set-up-guide.html>